

GWAL-CCSK Countersunk Closed End Threaded Insert

Aluminium · Countersunk · Round · Closed end
M4 - M8

Features

- Designed to provide load bearing threads in thin sheet materials
- Countersunk head flush installation and clamp up
- Closed end prevents the ingress of dirt and fluids into thread and electrical circuits

Material

- Aluminium 5052

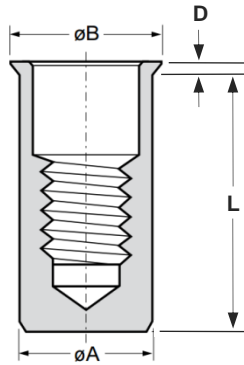

Before Placement

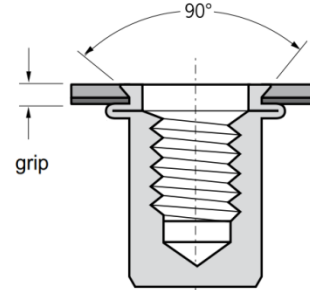

After Placement

Part No.	Thread Size	Grip Range		Hole Size	ϕA	ϕB	D	L
		min.	max.					
GWAL-CCSKM4-1735	M4	1.7	3.5	6.0	6.0	9.0	1.5	15.0
GWAL-CCSKM4-3550		3.5	5.0					17.0
GWAL-CCSKM5-1740	M5	1.7	4.0	7.0	7.0	10.0	1.5	18.0
GWAL-CCSKM5-4065		4.0	6.5					20.5
GWAL-CCSKM6-1745	M6	1.7	4.5	9.0	9.0	12.0	1.5	22.0
GWAL-CCSKM6-4565		4.5	6.5					24.0
GWAL-CCSKM8-1745	M8	1.7	4.5	11.0	11.0	14.0	1.5	25.0
GWAL-CCSKM8-4565		4.5	6.5					28.0

Thread Size	Max. torque	Pull-out	Torque-to-turn	Shear strength
	Nm max.	Kn	Nm	kN
M4	~4.9	> ~4.5	~1.4	~1.1
M5	~4.9	> ~5.2	~1.5	~1.6
M6	~16.0	> ~10.5	~3.2	~2.4
M8	~33.0	> ~15.0	~5.3	~2.9